

# CASTLE PINES NORTH

## CASTLE PINES PARKWAY MEDIAN IMPROVEMENTS

### LANDSCAPE PLANT LIST

QTY.	SYM.	COMMON NAME	BOTANICAL NAME	SIZE & COND.
(UNLESS OTHERWISE NOTED)				
<b>TREES</b>				
4	BTM	BIGTOOTH MAPLE	ACER GRANDIDENTATUM	# 15
4	BTM	BIGTOOTH MAPLE	ACER GRANDIDENTATUM	6' CLUMP B#B
16	SBC	SHADBLOW HERONBERBERRY	AMELANCHIER CANADENSIS	# 15
13	RHC	RUSSIAN HAWTHORN	CRATAEGUS AMOURENSIS	6' CLUMP B#B
8	TCC	THORNLESS COCKSPUR HAWTHORN	CRATAEGUS CRUDS-GALLI INERMIS	# 15
8	WKL	WINTER KING HAWTHORN	CRATAEGUS VIRIDIA WINTER KING	6' CLUMP B#B
7	PRF	PEARLFIRE CRABAPPLE	MALUS PEARLPIRE	# 15
4	STI	SARGENT TINA CRABAPPLE	MALUS SARGENT TINA	# 15
<b>DECIDUOUS SHRUBS-</b>				
182	CPB	CRIMSON PGMY BARBERRY	BERBERIS THUNBERGII ATROPURPUREA NANA	5 GAL. CONT.
91	NAJ	NINEBARK, AMBER JIBBLEE	PHYSCOCARPUS OPULIFOLIUS 'JEFAMI'	5 GAL. CONT.
13	NDI	NINEBARK, DIABOLO	PHYSCOCARPUS OPULIFOLIUS 'MONLO'	5 GAL. CONT.
46	PTG	GLOBE PEASHRUB	CARAGANA FRUTEX 'GLOBOSA'	5 GAL. CONT.
12	VMO	MOHICAN VIBURNUM	VIBURNUM LANITANA 'MOHICAN'	5 GAL. CONT.
34	ARH	HONEYBUCKLE, ARNOLD RED	LONICERA TATARICA 'ARNOLD RED'	5 GAL. CONT.
4	RSE	SERICEGERBERRY, REGENT	AMELANCHIER ALNIFOLIA 'REGENT'	5 GAL. CONT.
16	MKL	MESSE KIM DWARF LILAC	SYRINGA FAYUVA 'MESS KIM'	5 GAL. CONT.
71	B9G	SPRING GOLD BROOM	SYRINGA FAYUVA 'SPRING GOLD'	5 GAL. CONT.
14	DKL	DWARF KOREAN LILAC	SYRINGA WETTERI 'ROYALTY'	5 GAL. CONT.
34	FER	FERREBUSH	CHAMAEBATIARIA WILLETOLUUM	5 GAL. CONT.
16	HTT	TINY 'RUMFETTS' HONEYBUCKLE	LONICERA SYRINGANTHA 'WOLFFI'	5 GAL. CONT.
16	BDW	BUTTERFLY BUSH, DWARF	BUDDLEIA DAVIDII	5 GAL. CONT.
100	CWL	COMMON WHITE LILAC	SYRINGA VILGARIS ALBA	5 GAL. CONT.
<b>EVERGREEN SHRUBS</b>				
148	GSP	GLOBE SPRUCE	PICEA PUNGENS 'GLOBOSA'	3 GAL. CONT.
54	MCS	SPRUCE, MRS. CESARINI	PICEA PUNGENS 'MRS. CESARINI'	3 GAL. CONT.
26	RHM	RH. MONTGOMERY SPRUCE	PICEA PUNGENS 'R.H. MONTGOMERY'	3 GAL. CONT.
63	SOS	SPRUCE, SERBIAN SPREADING	PICEA OMORICA 'NANA'	3 GAL. CONT.
116	MSL	MUGO SLOWGROW PINE	FINUS MUGO 'SLOWGROW'	3 GAL. CONT.
41	MWB	MUGO PINE, WHITE BUD	FINUS MUGO 'WHITE BUD'	3 GAL. CONT.
94	MJI	JUNIPER, MOTHER LODGE	JUNIPERUS CHINENSIS 'MOTHER LODGE'	3 GAL. CONT.
<b>GRASSES</b>				
70	AVG	BLUE ALENA GRASS	HELICTOTRICHON SEMPERVIRENS	4" POTS
99	DMG	DWARF MAIDEN GRASS (YAKU JIMA)	MISCANTHUS SINENSIS 'YAKU JIMA'	4" POTS
176	FRY	VARIATED FEATHER REED GRASS	CALAMAGROSTIS ACUTIFLORA 'AVALANCHE'	4" POTS
141	GHM	HEAVY METAL SWITCH GRASS	PANICUM VIRGATUM 'HEAVY METAL'	4" POTS
105	HFG	HARDY FOUNTAIN GRASS	FENISTETUM ALOPECUROIDES 'HAMLEN'	4" POTS
98	MMG	MAIDEN GRASS, MORNING LIGHT	MISCANTHUS SINENSIS 'MORNING LIGHT'	4" POTS
174	VMG	VARIATED MAIDEN GRASS	MISCANTHUS SINENSIS 'VAREGATUS'	4" POTS
<b>PERENNIALS/GROUND COVERS</b>				
212	HBF	HUMMINGBIRD FLOWER	ZAUSCHNERIA CALIFORNICA LATIFOLIA	1 GAL. CONT.
24	TIC	TICKSEED	COREOPSIS TICKSEED	1 GAL. CONT.
74	PRC	PURPLE ROCK CRESS	AUBRIETIA DELTOIDES	1 GAL. CONT.
130	FLB	FLAX, BLUE	LINUM FERRENNE	1 GAL. CONT.
38	BES	BLACK EYED SUSAN	RUDBECKIA FULGIDA 'GOLDSTURM'	1 GAL. CONT.
185	BOG	BASKET OF GOLD	AURINNA SAKATILUS 'GOLD BALL'	1 GAL. CONT.
81	CFI	PURPLE CONEFLOWER	ECHINACEA PURPUREA	1 GAL. CONT.
40	CFW	WHITE CONEFLOWER	ECHINACEA PURPUREA 'ALBA'	1 GAL. CONT.
91	CMW	CATMINT	HEMPTA X FAASSENII	1 GAL. CONT.
232	SDO	STELA DJORO DAYLILY	HEMEROCALLIS 'STELA DJORO'	1 GAL. CONT.
111	PJT	PUSSTOES	ANTENNARIA PUSSTOES	1 GAL. CONT.
18	RHF	RED HOT POKER	KNIPHOTHIA UVARIA	1 GAL. CONT.
80	YAM	MOONSHINE YARROW	ACHILLEA MOONSHINE	1 GAL. CONT.
116	YAP	PAPRIKA YARROW	ACHILLEA MILLEFOLIUM 'PAPRIKA'	1 GAL. CONT.
36	FRN	BEARDTONGUE/STEMION	FENISTEMON BEARDTONG	1 GAL. CONT.
129	MFA	PANCHITO MANANITA	ARCTOSTAPHYLOS SANITI	1 GAL. CONT.
148	LWO	FLUMBAGO	CERATOSTIGMA FLUMBAGINODES	1 GAL. CONT.
220	LPF	ICE PLANT, FIRE SPINNER	DELISOFERMA FIRE SPINNER	1 GAL. CONT.
25	TV	ICE PLANT, VERONICA	VERONICA UWANENSIS	1 GAL. CONT.
8	IPY	ICE PLANT, YELLOW	DELISOFERMA NUBIGENDUM	FLATS

### CONTEXT MAP:

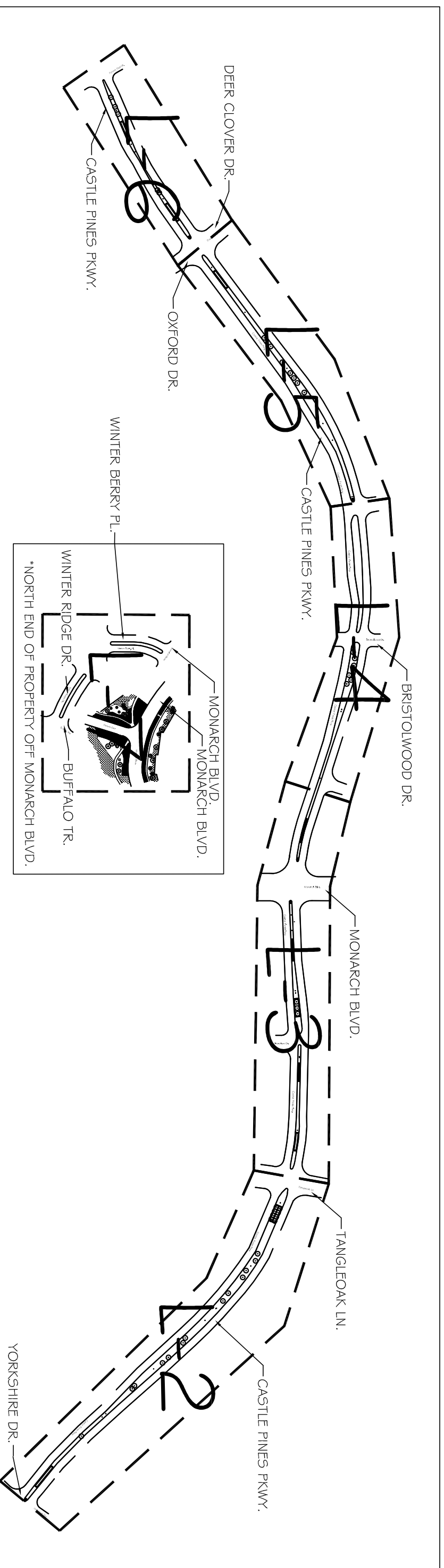

### LANDSCAPE NOTES:

- ALL LANDSCAPED AREAS ARE TO RECEIVE ORGANIC SOIL PREPARATION AT 5 CUBIC YARDS/1,000 SQ FT.
- CONTRACTOR SHALL SEED ALL NON SODDDED AREAS WHICH ARE DISTURBED BY GRADING WITH THE DRY AND SEED MIX. SOIL PREPARATION FOR SEEDDED AREAS ARE TO BE 3:5 CUBIC YARD/1,000 SQ FT.
- ALL SHRUB AND PERENNIAL BEDS ARE TO BE MULCHED WITH MIN. 2" DEPTH, GORILLA HAIR ORGANIC MULCH. MULCH IS TO BE REMOVED FROM THE TRUNK OF THE TREE SO THAT NO MULCH IS IN CONTACT WITH THE TREE. NO WEED CONTROL FABRIC IS TO BE USED UNDER MULCH.
- SHRUB BEDS ARE TO BE CONTAINED BY 4" x 14 GAUGE GALVANIZED EDGER, RYERSON OR EQUAL. EDGER IS NOT REQUIRED WHEN ADJACENT TO CURBS, WALLS, OR WALKS.
- ALL SODDDED AREA THAT ARE MODIFIED WILL NEED TO HAVE SPRINKLERS HEADS ADJUSTED SO TO ACCOMMODATE THE NEW LAYOUT.
- THE CONTRACTOR IS RESPONSIBLE FOR THE COST TO REPAIR UTILITIES, ADJACENT LANDSCAPE, PUBLIC AND PRIVATE PROPERTY THAT IS DAMAGED BY THE CONTRACTOR OR THEIR SUBCONTRACTORS OPERATIONS DURING INSTALLATION OR DURING THE SPECIFIED MAINTENANCE PERIOD. CALL FOR UTILITY LOCATIONS PRIOR TO ANY EXCAVATION.
- THE CONTRACTOR SHALL REPORT ANY DISCREPANCY IN PLAN VS. FIELD CONDITIONS IMMEDIATELY TO THE LANDSCAPE ARCHITECT, PRIOR TO CONTINUING WITH THAT PORTION OF WORK.
- THE CONTRACTOR SHALL BE RESPONSIBLE FOR THE REPAIR OF ANY OF THEIR TRENCHES OR EXCAVATIONS THAT SETTLE.
- DO NOT DISTURB THE EXISTING PAVING, LIGHTING, LANDSCAPING, OR IRRIGATION THAT EXISTS ADJACENT TO THE SITE UNLESS OTHERWISE NOTED ON PLAN.
- THE CONTRACTOR IS RESPONSIBLE FOR VERIFYING ALL PLANT QUANTITIES.
- THE CONTRACTOR SHALL SUBMIT SAMPLES OF ALL MATERIAL TO OWNERS REPRESENTATIVE PRIOR TO INSTALLATION.
- CONTRACTOR SHALL INSTALL ALL PLANT MATERIAL PER DETAILS.
- CONTRACTOR SHALL SCHEDULE SITE INSPECTION WITH OWNERS REPRESENTATIVE WEEKLY TO MONITOR PROGRESS.
- ALL PROPOSED PLANTINGS IN NATIVE AND CRUSHER FINES AREAS SHALL INCLUDE A 4" DIA. RING OF MULCH AND THE APPROPRIATE IRRIGATION.
- ALL IRRIGATION SHALL BE METAFAM OR DRIP IRRIGATION. PLANTINGS WITH SIMILAR WATER REQUIREMENTS SHALL BE ZONED TOGETHER.
- ALL IRRIGATION WILL BE DESIGN AND INSTALLED IN THE FIELD. NO IRRIGATION PLANS WILL BE PROVIDED.
- CRUSHER FINES SHALL BE INSTALLED AT A DEPTH OF 3" OVER LANDSCAPE FABRIC.

### DRYLAND SEED MIX

COMMON NAME	SCIENTIFIC NAME	% OF TOTAL	PLS PER ACRE
WESTERN WHEATGRASS	AGROPERON SMITHII	28%	6.2 LBS.
BIG BLUESTEM	ANDROPOGON GRACIDI	28%	6.2 LBS.
SIDE OATS GRAMA	BOUTELOUA CURTIPENDULA	10%	2.2 LBS.
BLUE GRAMA	BOUTELOUA GRACILIS	6%	1.2 LBS.
SWITCHGRASS	PANICUM VIRGATUM	10%	2.2 LBS.
INDIANGRASS	SORGHASTRUM NUTANS	10%	2.2 LBS.
LITTLE BLUESTEM	SCHIZACHRYSIUM SCOPARUS	8%	1.8 LBS.
TOTAL		100%	22.0 LBS.

### TREE PLANTING DETAIL

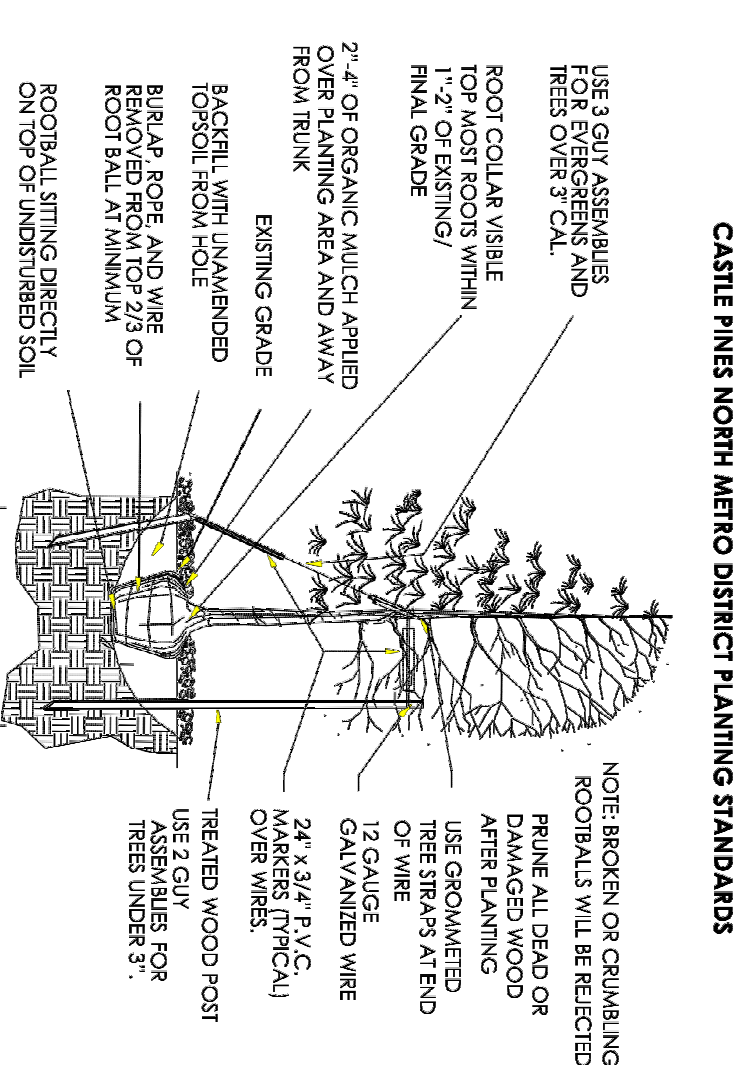

- Excavate planting hole with existing grade. Make preparations as shown there is to be a 2" root ball diameter and no deeper than the distance from the top most roots in the root ball to the bottom of the root ball to allow for settling. Do not disturb soil at bottom of planting hole, but do across the sides of the planting hole. The planting area shall be loosened and aerated at least three times the diameter of the root ball. Backfill shall consist of existing soil on top and no amendments shall be used unless otherwise specified.
- Trees shall be staked with the root collar/line visible above grade AND two or more structural roots located one side of the tree. The tree shall be staked so that the visible root collar shall be visible. Do not cover the root ball with soil.
- When root ball will remain intact, cut off bottom 1/3 of wire basket before placing tree in hole. Cut off remainder of basket AFTER tree is in hole, remove basket completely. As a minimum, the top 2/3 of the basket and basket shall be removed from the root ball on all trees. Remove all nylon ties, wire, rope and twine. Remove unnecessary planting material.
- Form soil into a 3" to 5" tall watering ring (around planting area). This is not necessary in irrigated turf situations.
- Staking: Apply 2" to 3" diameter stakes to support tree during the first year. Stakes shall be made of treated 2x4s. Staking may be required to stabilize trees. Staking and guying must be removed within 1 year of planting date.
- Three wires is to be used on new plantings, except in late fall planting situations, and only after consultation with the Parks & Open Space Manager.
- Restoring of improperly planted trees will only be allowed if it is determined that doing so will in no way compromise the root ball, and shall only be done with approval of the Parks & Open Space Manager.

### SHRUB PLANTING DETAIL

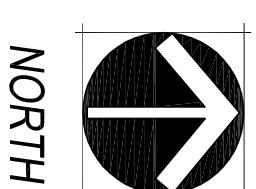
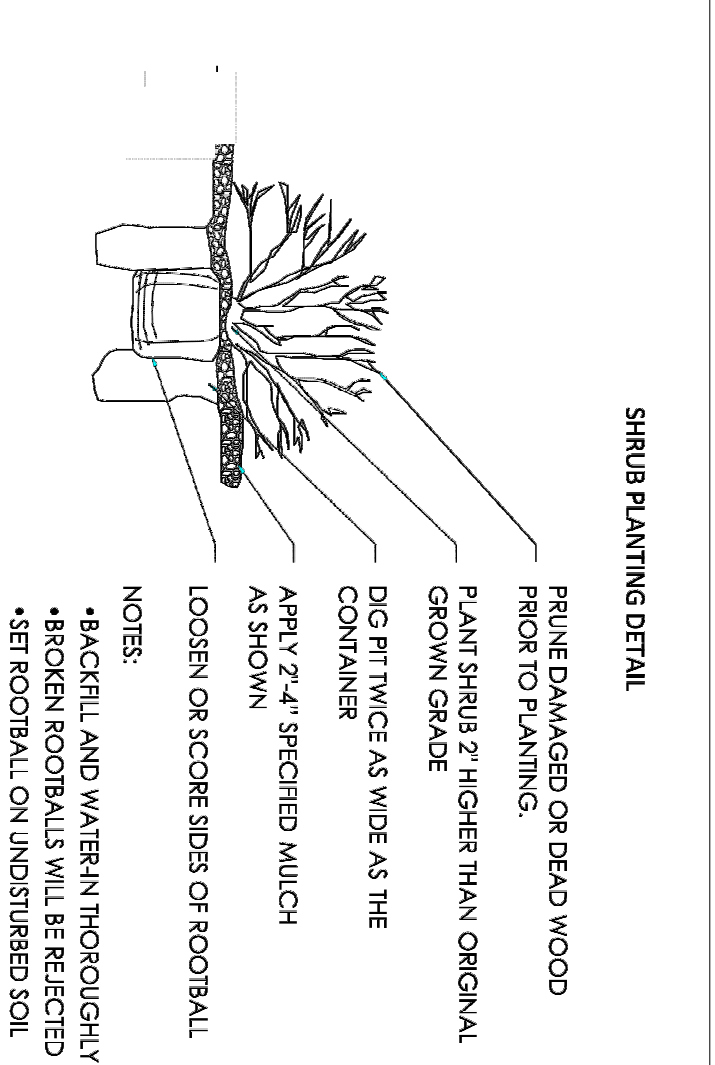

Landscape Architecture & Construction Management  
Parker, Colorado  
720.301.7404



Plan Date:  
May 8, 2015-Bid Set

Castle Pines North  
Castle Pines North, CO 80108

SHEET  
L-1

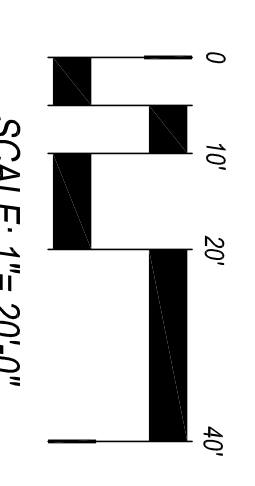
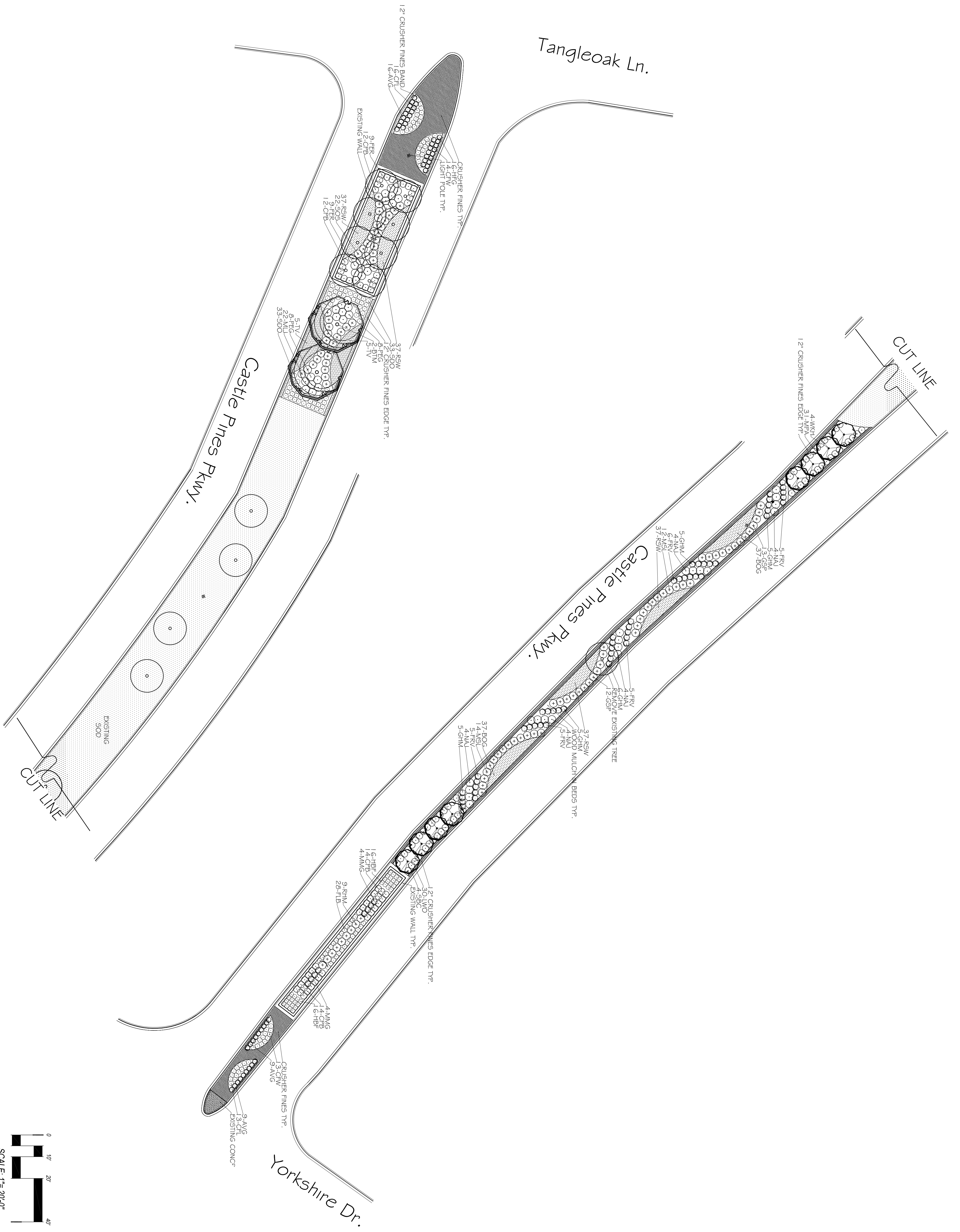

SHEET  
L-2

Castle Pines North  
Castle Pines North, CO 80108

Plan Date:  
May 8, 2015-Bid Set



Landscape Architecture &  
Construction Management  
Parker, Colorado  
720.301.7404

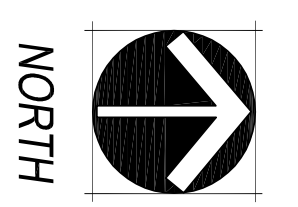



Bristolwood Dr.

5 TYP.

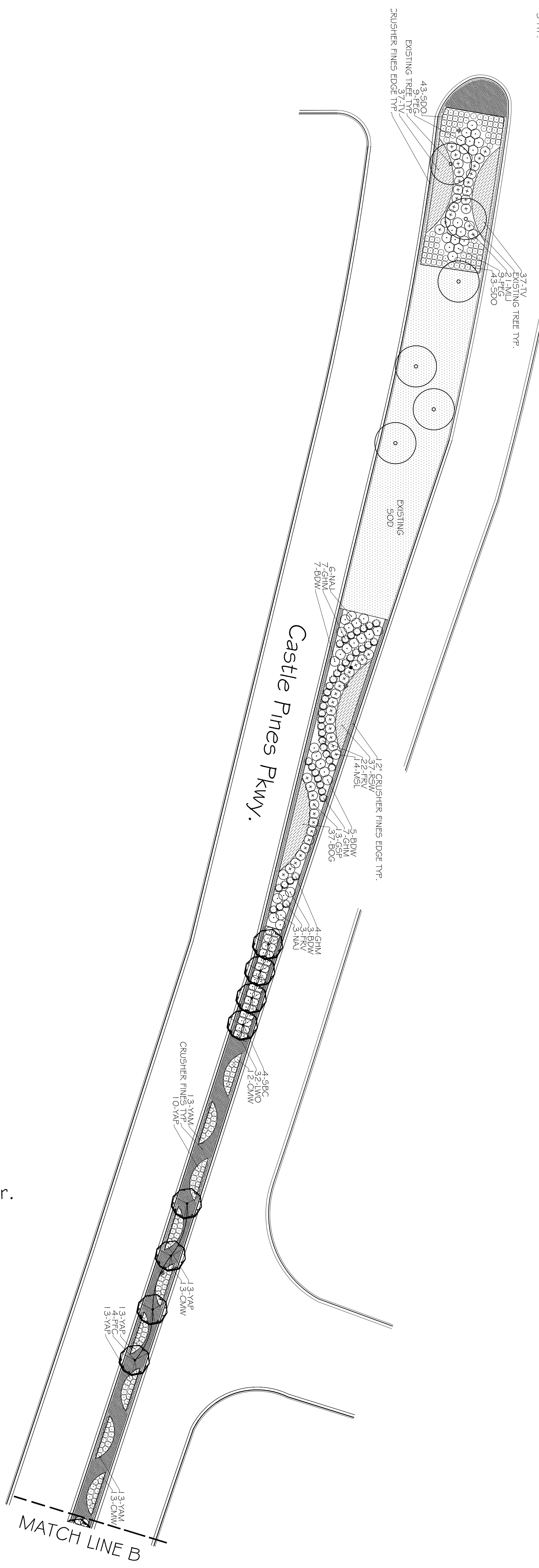

Castle Pines Pkwy.

Bristolwood Dr.

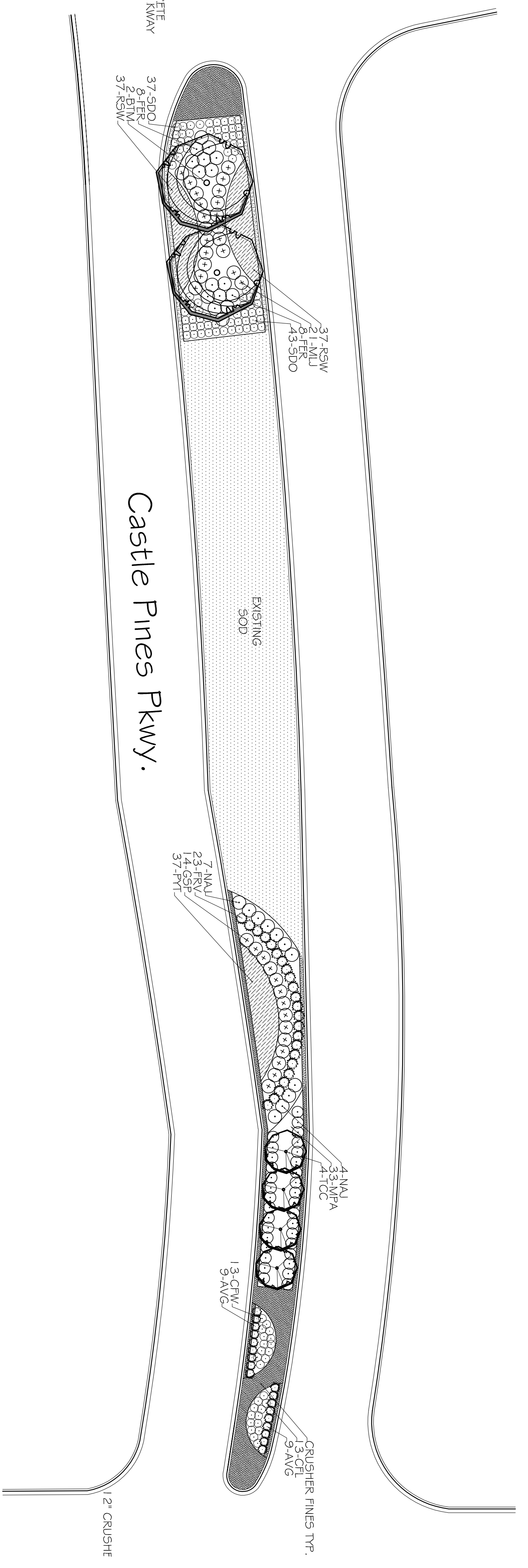

Castle Pines Pkwy.

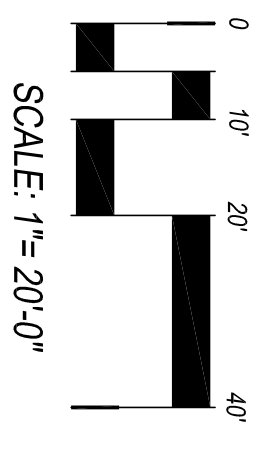

SHEET  
L-4

Castle Pines North  
Castle Pines North, CO 80108

Plan Date:  
May 8, 2015-Bid Set



Landscape Architecture &  
Construction Management  
Parker, Colorado  
720.301.7404

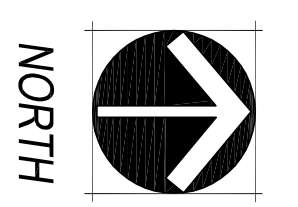



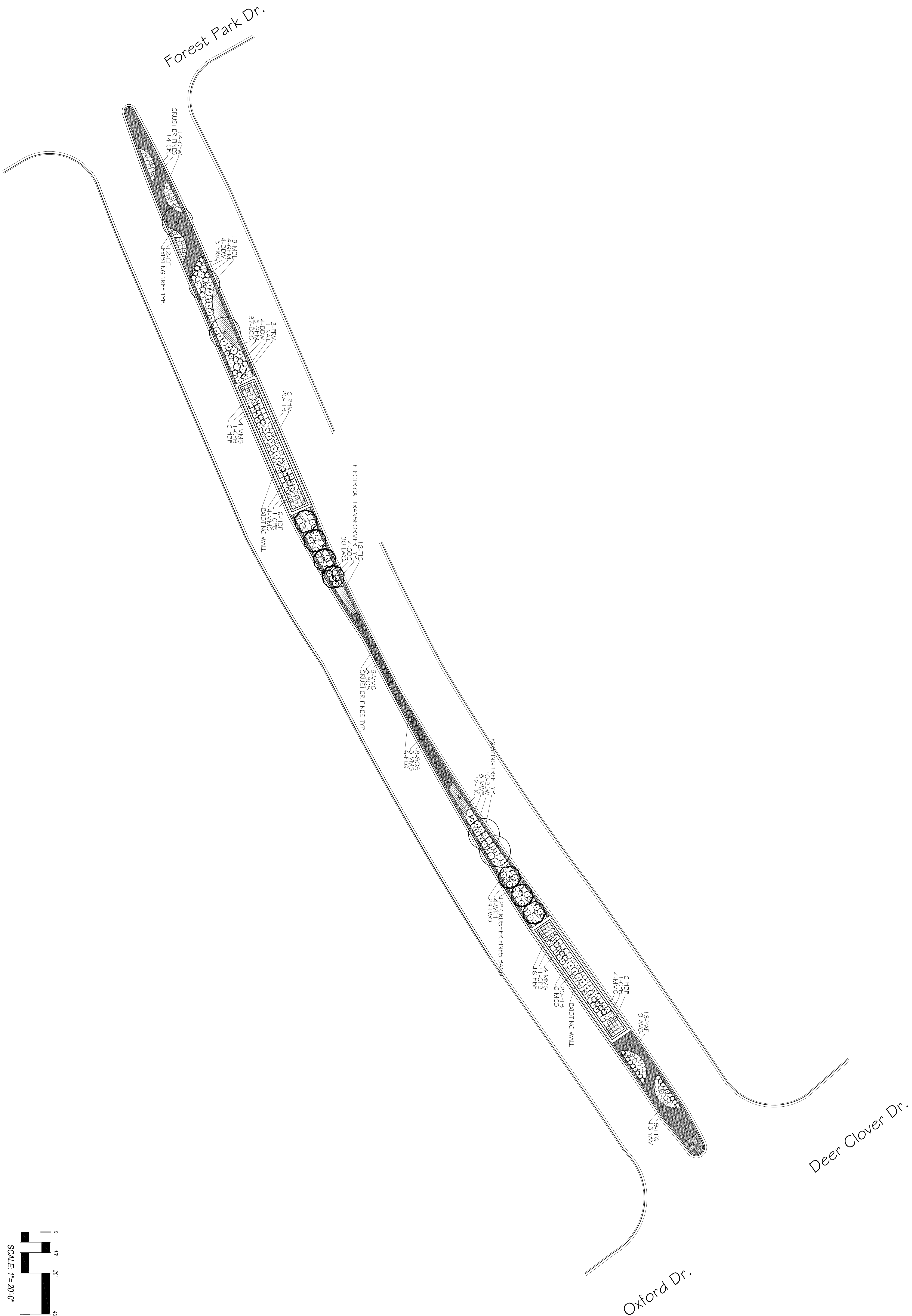

Forest Park Dr.

Deer Clover Dr.

Oxford Dr.

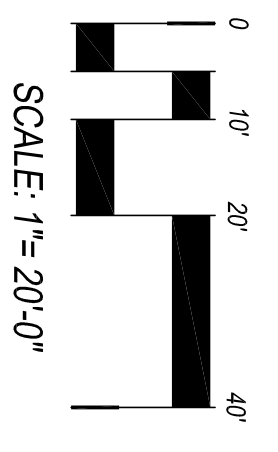

SHEET  
L-6

Castle Pines North  
Castle Pines North, CO 80108

Plan Date:  
May 8, 2015-Bid Set



Landscape Architecture &  
Construction Management  
Parker, Colorado  
720.301.7404

